

ROECO

# Bearing Data

## Ball Bearing Units

Bearing No. : **UKP328+H2328**

Dimensions

H = 200

L = 620

J = 500

N1 = 55

H1 = 80

H2 = 388

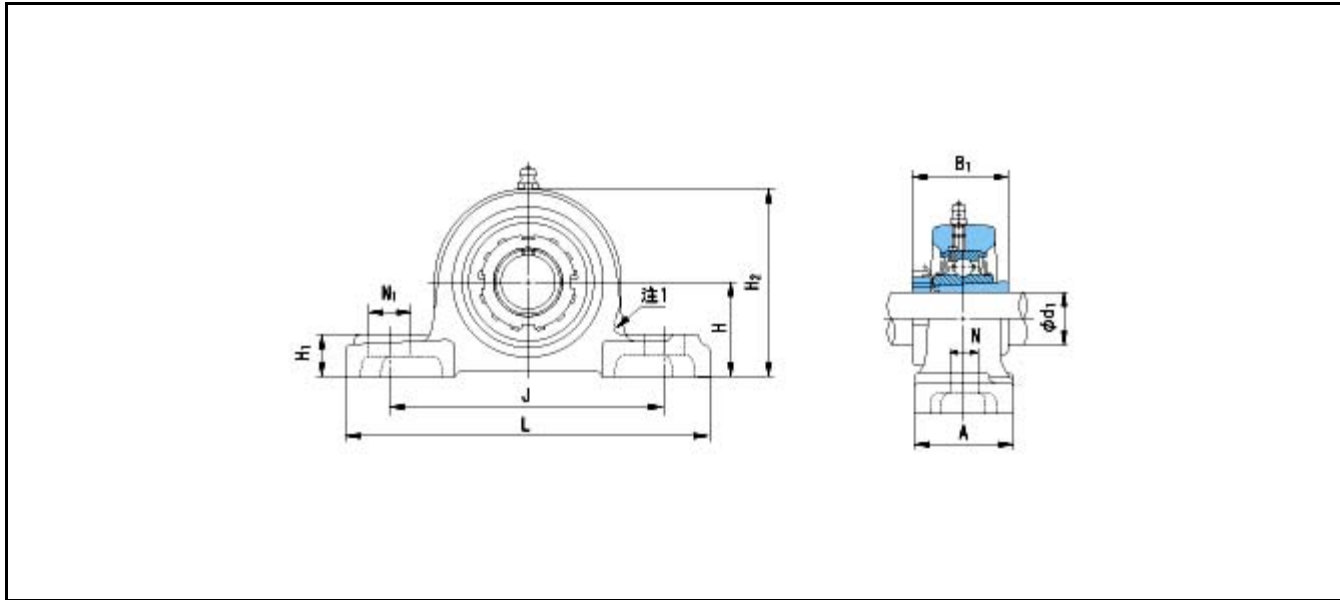

Dimensions

d1 = 125

A = 140

N = 40

B1 = 131

Mass = 89.4 kg

Basic Dynamic Load Rating Cr :	<b>255000 N</b>	INNER RING	OUTER RING
Basic Static Load Rating Cor :	<b>246000 N</b>	O.D.Surface Runout with Side :	-
Limiting Speed ;		Axial Runout with Bore :	-
Grease Lubrication :	- rpm	Axial Runout with Raceway :	-
Oil Lubrication :	- rpm	Width Variation :	-
		Radial Runout :	-