

ROECO

Bearing Data

Ball Bearing Units

Bearing No. : **UKP305+H2305**

Dimensions

H = 45
L = 175
J = 132
N1 = 20
H1 = 16
H2 = 84

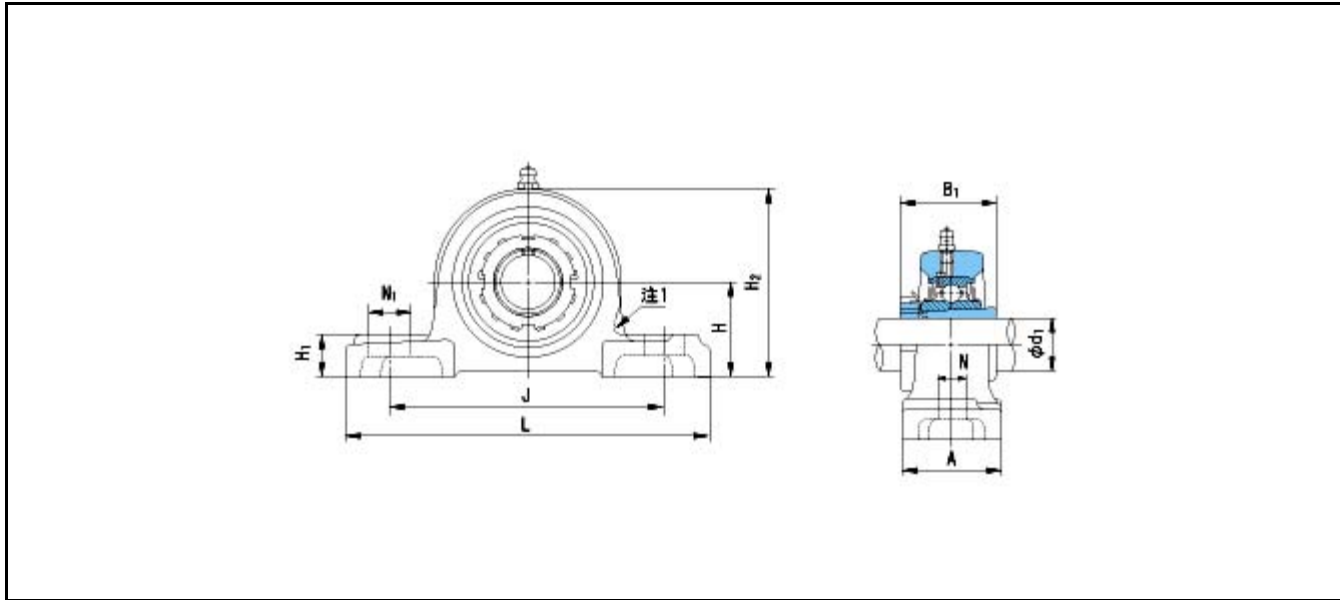

Dimensions

d1 = 20
A = 45
N = 17
B1 = 35
Mass = 1.6 kg

Basic Dynamic Load Rating Cr :	21300 N	INNER RING	OUTER RING
Basic Static Load Rating Cor :	10900 N	O.D.Surface Runout with Side :	-
Limiting Speed ;		Axial Runout with Bore :	-
Grease Lubrication :	- rpm	Axial Runout with Raceway :	-
Oil Lubrication :	- rpm	Width Variation :	-
		Radial Runout :	-