

ROECO

Bearing Data

Ball Bearing Units

Bearing No. : **UKFL310+H2310**

Dimensions

H = 240

L = 140

J = 187

N = 25

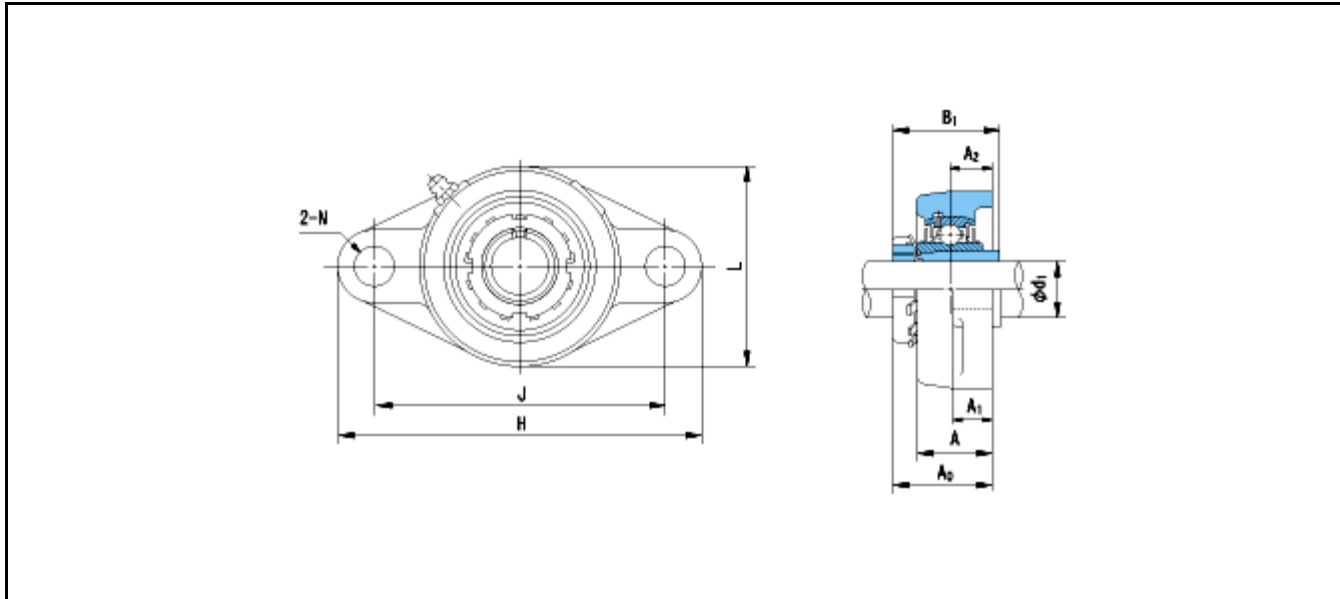

Dimensions

d1 = 45

A1 = 19

A2 = 28

A = 48

A0 = 60

B1 = 55

Mass = 4.4 kg

Basic Dynamic Load Rating Cr :	61500 N		INNER RING	OUTER RING
Basic Static Load Rating Cor :	38200 N	O.D.Surface Runout with Side :		-
Limiting Speed ;		Axial Runout with Bore :	-	-
Grease Lubrication :	- rpm	Axial Runout with Raceway :	-	-
Oil Lubrication :	- rpm	Width Variation :	-	-
		Radial Runout :	-	-