

ROECO

Bearing Data

Ball Bearing Units

Bearing No. : **UKF210C+H2310**

Dimensions

L = 143

J = 111

N = 16

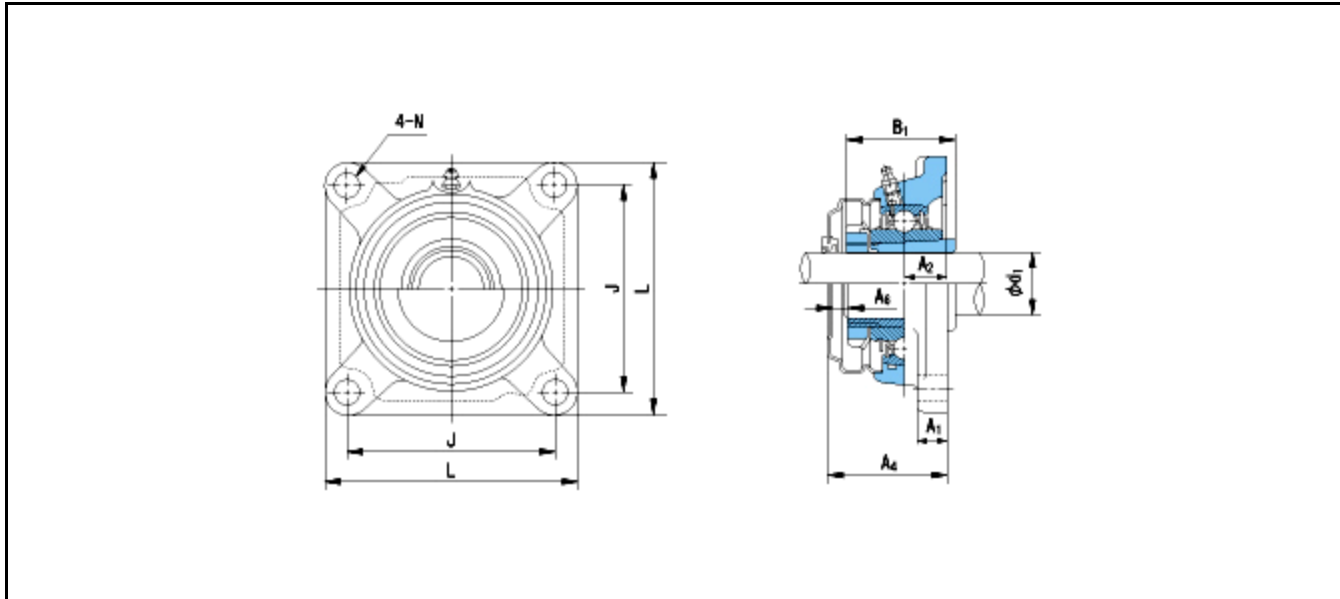

Dimensions

d1 = 45

A1 = 18

A2 = 22

B1 = 55

A4 = 66

A6 = 15

Mass = 2.8 kg

Basic Dynamic Load Rating Cr :	35500 N				
Basic Static Load Rating Cor :	23200 N	O.D.Surface Runout with Side :			-
Limiting Speed ;		Axial Runout with Bore :			-
Grease Lubrication :	- rpm	Axial Runout with Raceway :			-
Oil Lubrication :	- rpm	Width Variation :			-
		Radial Runout :			-