

ROECO

Bearing Data

Ball Bearing Units

Bearing No. : **UKF207E+H2307**

Dimensions

L = 117

J = 92

N = 14

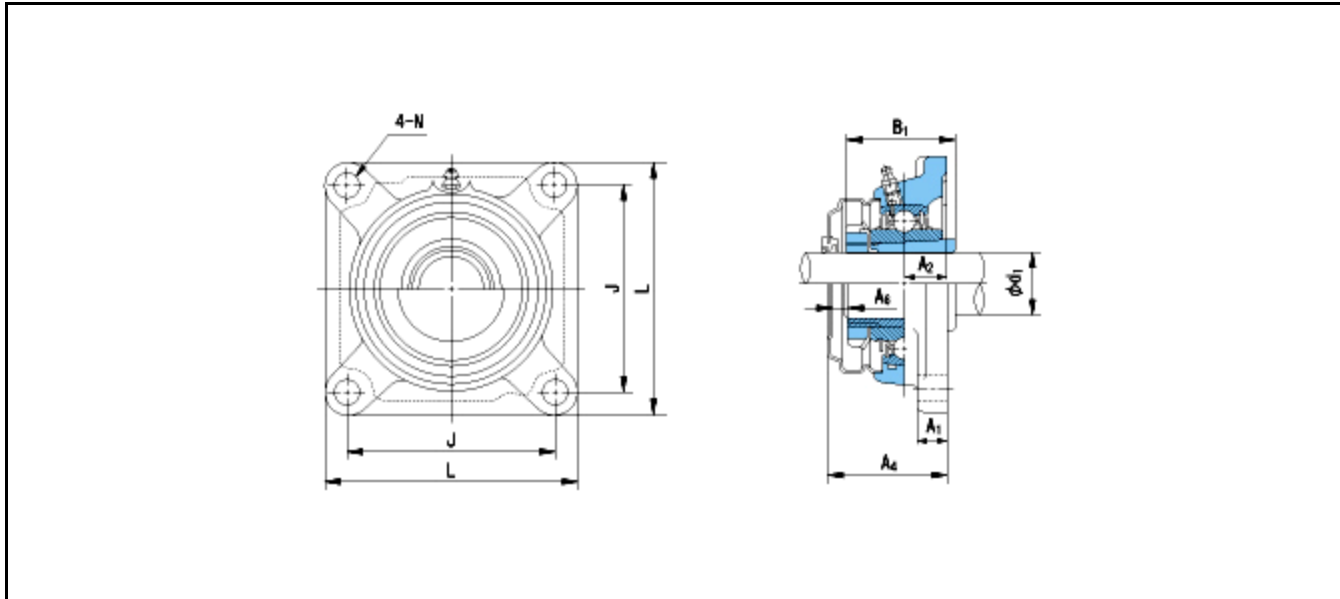

Dimensions

d1 = 30

A1 = 16

A2 = 19

B1 = 43

A4 = 54

A6 = 11

Mass = 1.7 kg

Basic Dynamic Load Rating Cr :	25900 N			
Basic Static Load Rating Cor :	15400 N	O.D.Surface Runout with Side :		-
Limiting Speed ;		Axial Runout with Bore :		-
Grease Lubrication :	- rpm	Axial Runout with Raceway :		-
Oil Lubrication :	- rpm	Width Variation :		-
		Radial Runout :		-