

ROECO

Bearing Data

Ball Bearing Units

Bearing No. : **UCT305**

Dimensions

- H = 89
- H2 = 62
- L = 122
- L1 = 76
- L2 = 12
- L3 = 65
- N = 26
- N1 = 16
- N2 = 36

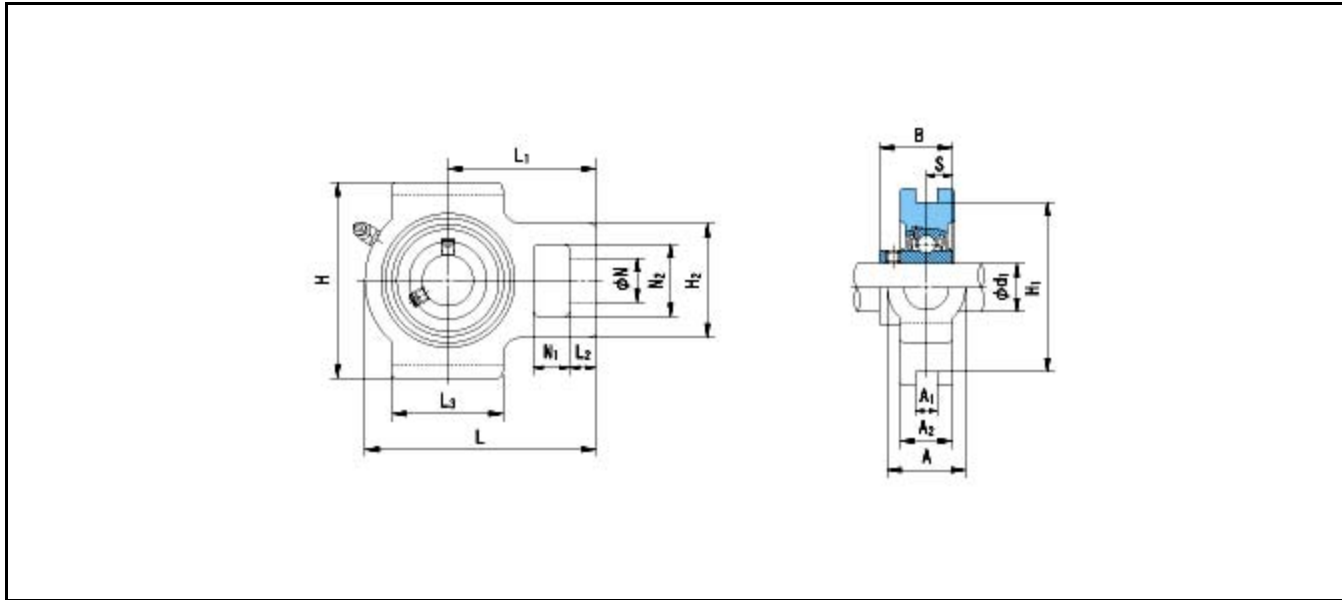

Dimensions

- d1 = 25
- A1 = 12
- A2 = 26
- A = 36
- H1 = 80
- B = 38
- S = 15
- Mass = 1.4 kg

Basic Dynamic Load Rating Cr :	21300 N	INNER RING	OUTER RING
Basic Static Load Rating Cor :	10900 N	O.D.Surface Runout with Side :	-
Limiting Speed ;		Axial Runout with Bore :	-
Grease Lubrication :	- rpm	Axial Runout with Raceway :	-
Oil Lubrication :	- rpm	Width Variation :	-
		Radial Runout :	-