

ROECO

Bearing Data

Ball Bearing Units

Bearing No. : **UCFL305**

Dimensions

H = 150

L = 80

J = 113

N = 19

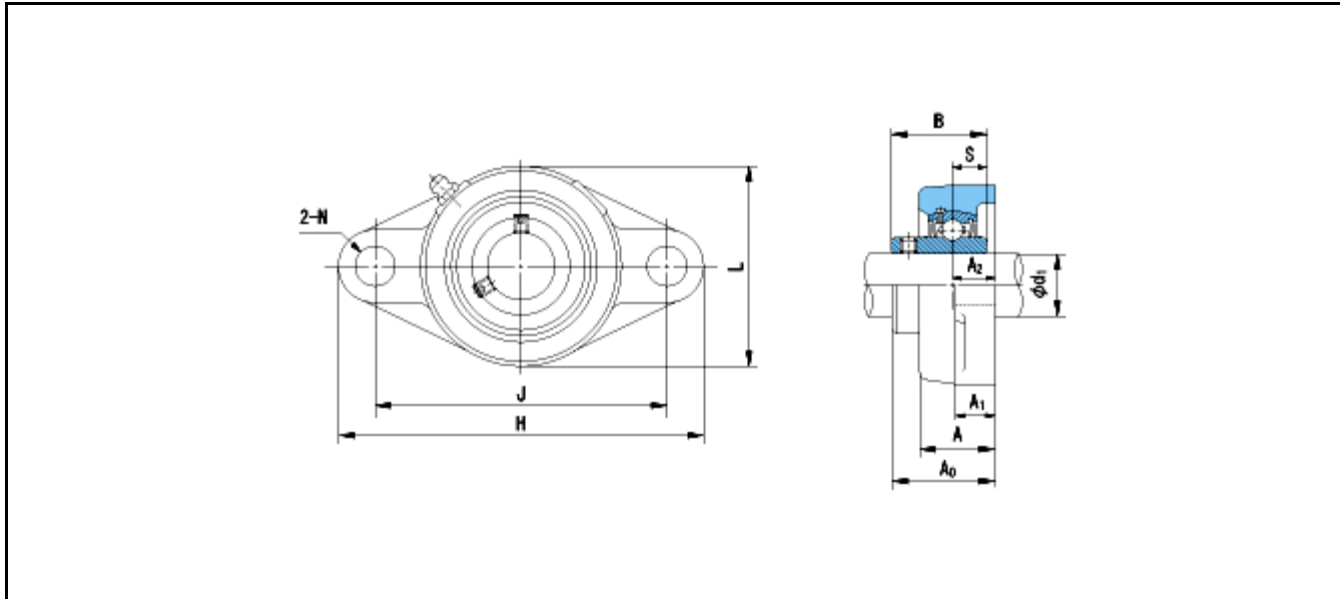

Dimensions

d1 = 25

A1 = 13

A2 = 16

A = 29

A0 = 39

B = 38

S = 15

Mass = 1.1 kg

Basic Dynamic Load Rating Cr :	21300 N	INNER RING	OUTER RING
Basic Static Load Rating Cor :	10900 N	O.D.Surface Runout with Side :	-
Limiting Speed ;		Axial Runout with Bore :	-
Grease Lubrication :	- rpm	Axial Runout with Raceway :	-
Oil Lubrication :	- rpm	Width Variation :	-
		Radial Runout :	-