

ROECO

Bearing Data

Ball Bearing Units

Bearing No. : **UCFCX16**

Dimensions

L = 260

J = 219

N = 23

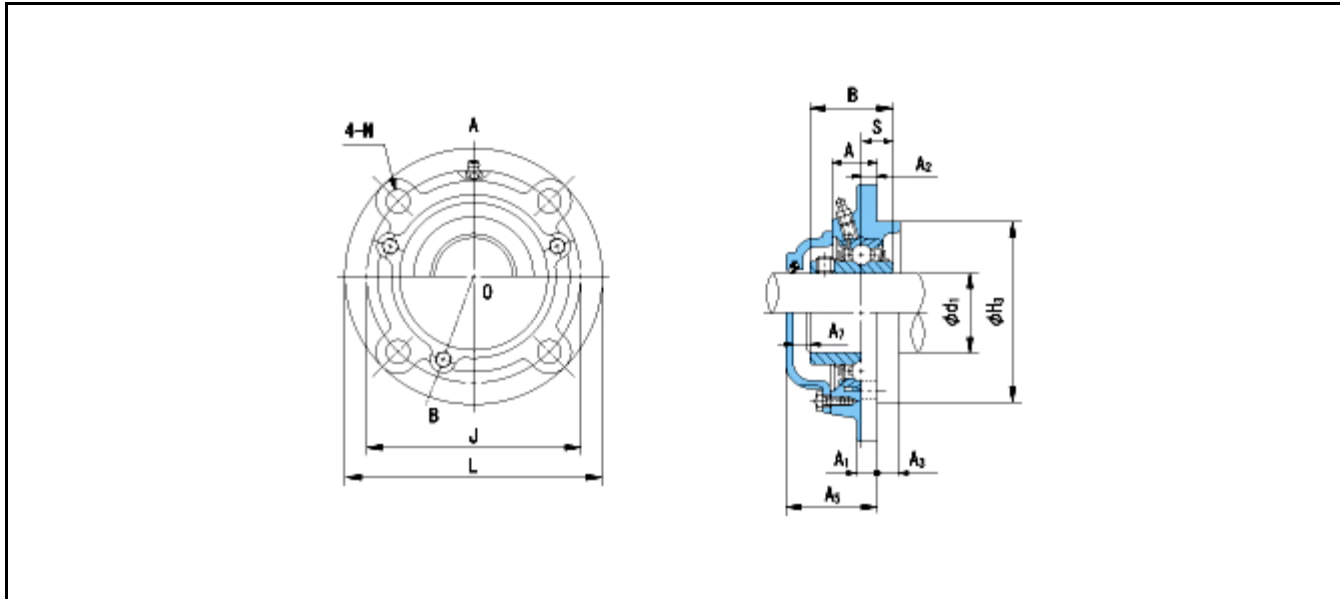

Dimensions

d1 = 80

A = 36

A1 = 19

A2 = 10

A3 = 25

H3 = 186

B = 85.7

S = 34.1

A0 = 61.6

Mass = 11.5 kg

Basic Dynamic Load Rating Cr : **83500 N**

Basic Static Load Rating Cor : **61800 N**

Limiting Speed ;

Grease Lubrication : - rpm

Oil Lubrication : - rpm

INNER RING OUTER RING

O.D.Surface Runout with Side : -

Axial Runout with Bore : -

Axial Runout with Raceway : -

Width Variation : -

Radial Runout : -