

ROECO

Bearing Data

Ball Bearing Units

Bearing No. : CUCF322C

Dimensions

L = 340

J = 266

N = 41

A = 96

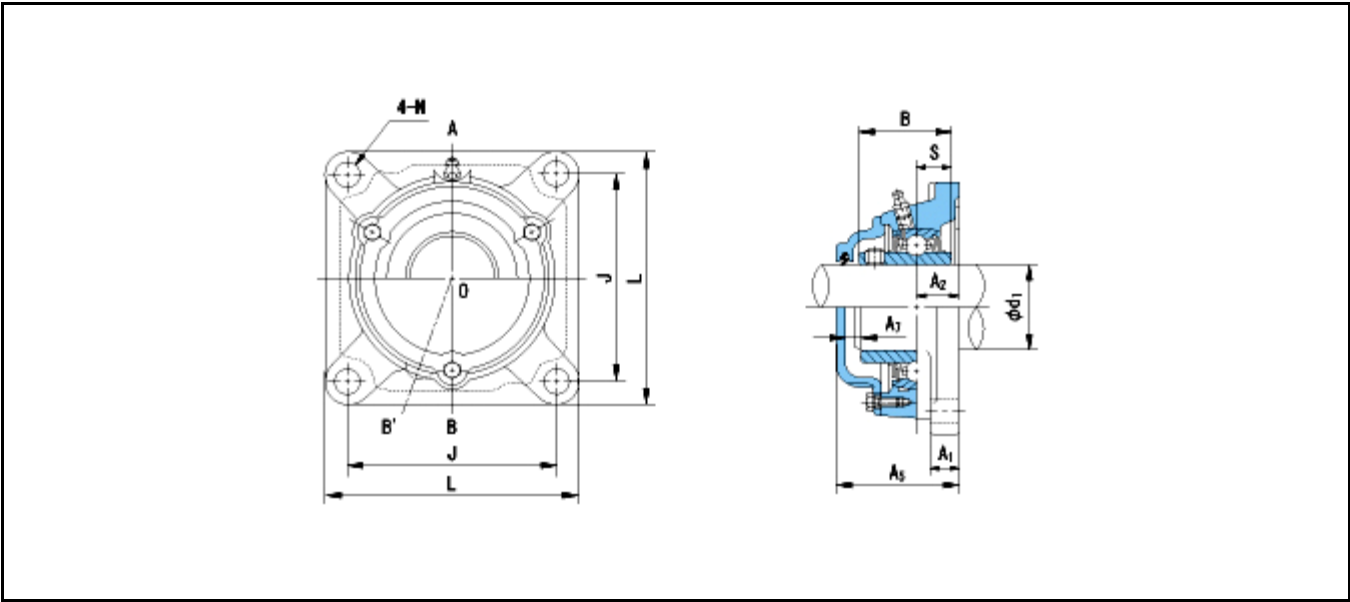

Dimensions

d1 = 110

A1 = 35

A2 = 60

B = 117

S = 46

A5 = 165

A7 = 26

Mass = 38.7 kg

Basic Dynamic Load Rating Cr :		205000 N	INNER RING		OUTER RING
Basic Static Load Rating Cor :		178800 N	O.D.Surface Runout with Side :	-	
Limiting Speed ;			Axial Runout with Bore :	-	
			Axial Runout with Raceway :	-	-
			Width Variation :	-	-
			Radial Runout :	-	-
Grease Lubrication :		- rpm			
Oil Lubrication :		- rpm			