

ROECO

Bearing Data

Ball Bearing Units

Bearing No. : CUCF205C

Dimensions

L = 95

J = 70

N = 12

A = 27

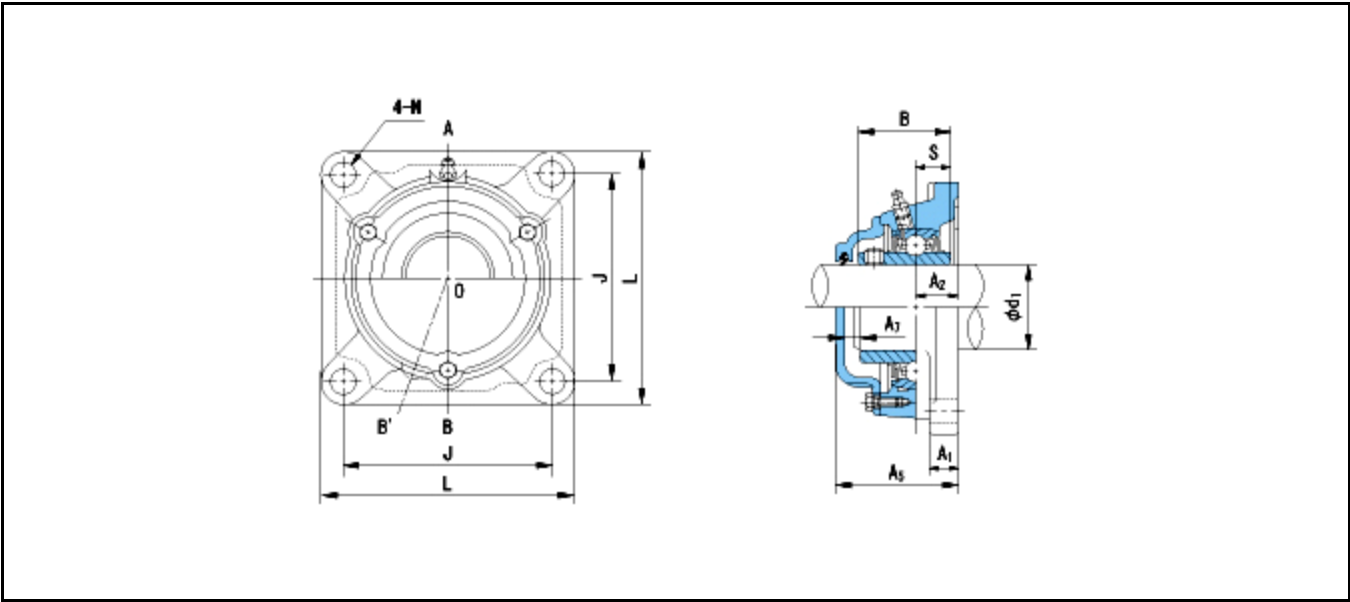

Dimensions

d1 = 25

A1 = 14

A2 = 16

B = 34

S = 14.3

A5 = 51

A7 = 9

Mass = 1.2 kg

Basic Dynamic Load Rating Cr :		14000 N	INNER RING		OUTER RING	
Basic Static Load Rating Cor :		7900 N	O.D.Surface Runout with Side :		-	
Limiting Speed ;		Axial Runout with Bore :		-		
		Axial Runout with Raceway :		-	-	
		Grease Lubrication :		- rpm	Width Variation :	
Oil Lubrication :		- rpm	Radial Runout :		-	-