

ROECO

Bearing Data

Ball Bearing Units

Bearing No. : CUCF204C

Dimensions

L = 86
J = 64
N = 12
A = 25.5

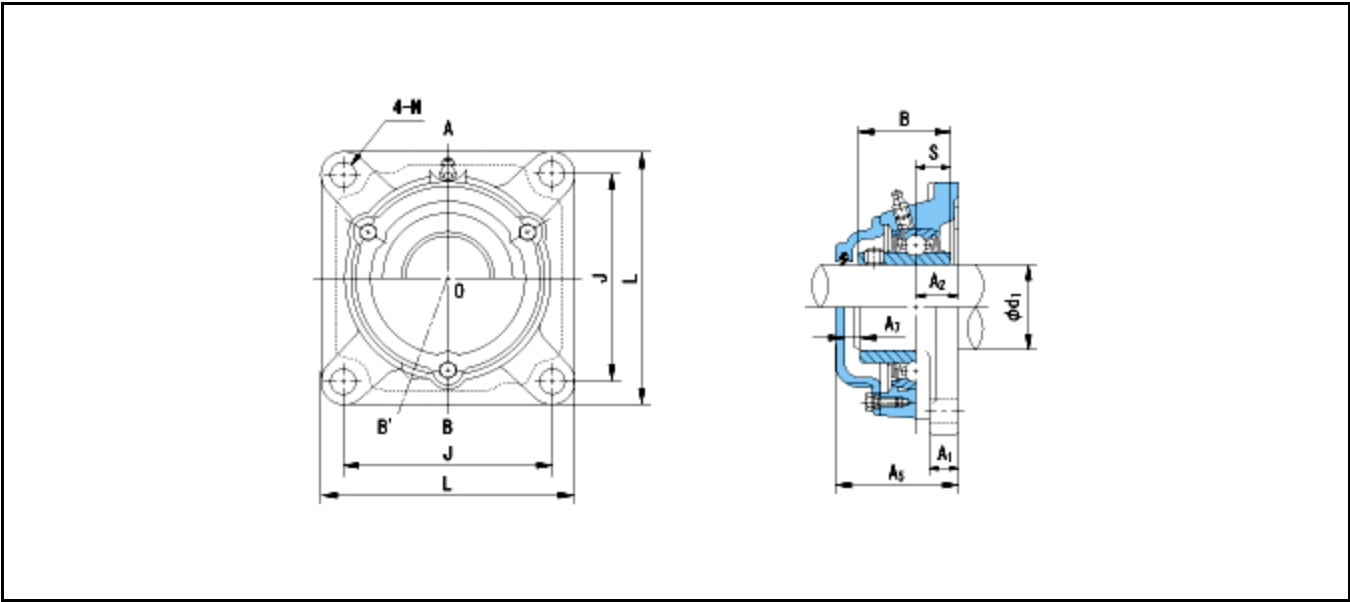

Dimensions

d1 = 20
A1 = 12
A2 = 15
B = 31
S = 12.7
A5 = 46
A7 = 6
Mass = 1 kg

Basic Dynamic Load Rating Cr :		12800 N	INNER RING		OUTER RING
Basic Static Load Rating Cor :		6600 N	O.D.Surface Runout with Side :	-	
Limiting Speed ;			Axial Runout with Bore :	-	
			Axial Runout with Raceway :	-	-
			Width Variation :	-	-
			Radial Runout :	-	-
Grease Lubrication :		- rpm			
Oil Lubrication :		- rpm			