

ROECO

Bearing Data

Ball Bearing Units

Bearing No. : CUCF203C

Dimensions

L = 86  
J = 64  
N = 12  
A = 25.5

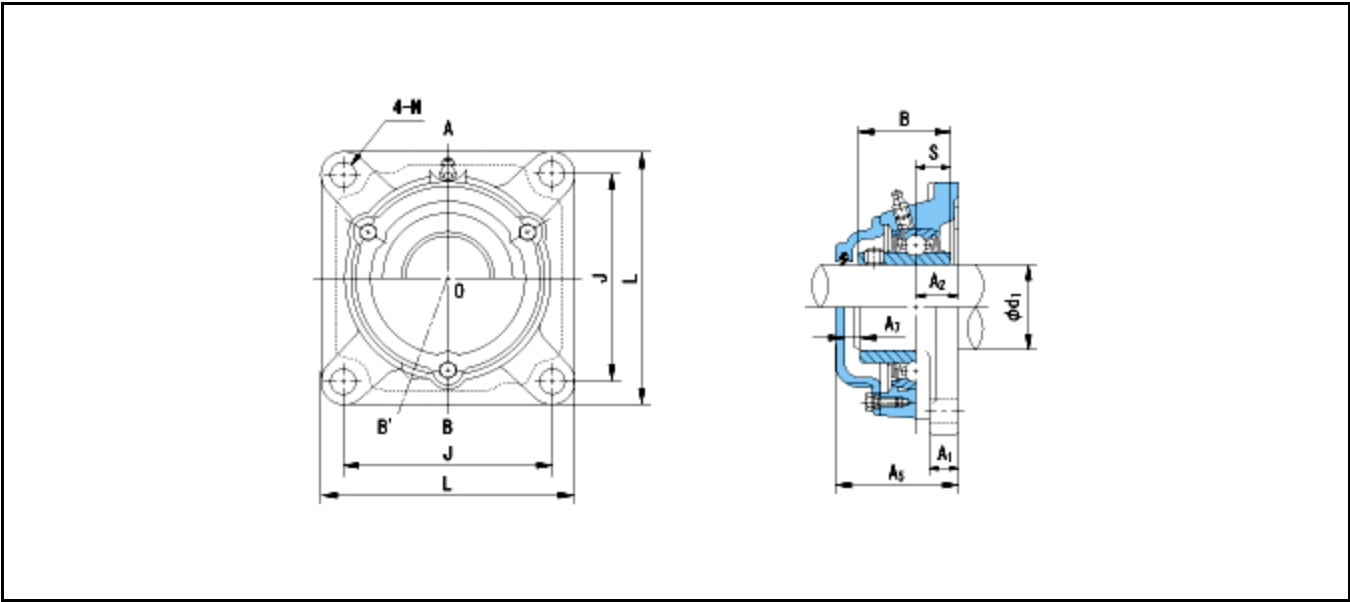

Dimensions

d1 = 17  
A1 = 12  
A2 = 15  
B = 31  
S = 12.7  
A5 = 46  
A7 = 6  
Mass = 1 kg

Basic Dynamic Load Rating Cr :		12800 N	INNER RING		OUTER RING	
Basic Static Load Rating Cor :		6600 N	O.D.Surface Runout with Side :		-	
Limiting Speed ;			Axial Runout with Bore :	-		
			Axial Runout with Raceway :	-	-	
			Width Variation :	-	-	
Grease Lubrication :		- rpm	Radial Runout :	-	-	
Oil Lubrication :		- rpm				