

ROECO

Bearing Data

Ball Bearing Units

Bearing No. : CUCF202C

Dimensions

- L = 86
- J = 64
- N = 12
- A = 25.5

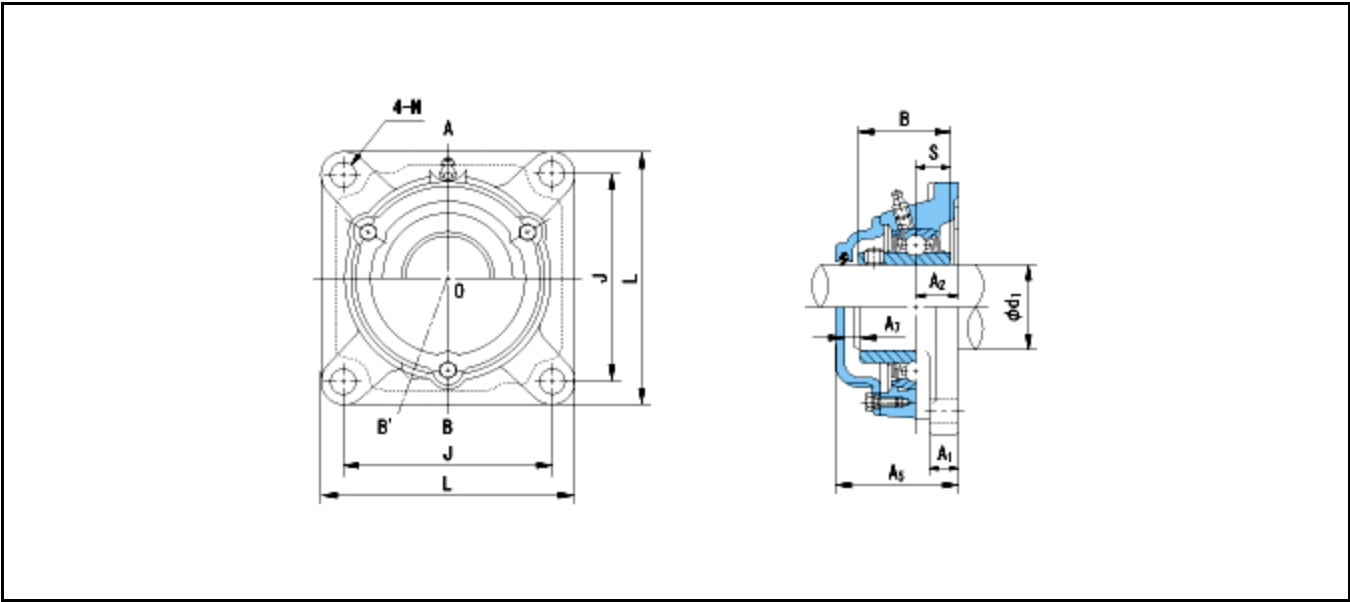

Dimensions

- d1 = 15
- A1 = 12
- A2 = 15
- B = 31
- S = 12.7
- A5 = 46
- A7 = 6
- Mass = 1 kg

Basic Dynamic Load Rating Cr :		12800 N	INNER RING		OUTER RING	
Basic Static Load Rating Cor :		6600 N	O.D.Surface Runout with Side :		-	
Limiting Speed ;		Axial Runout with Bore :		-		
		Axial Runout with Raceway :		-	-	
		Grease Lubrication :		- rpm	Width Variation :	
Oil Lubrication :		- rpm	Radial Runout :		-	-