

ROECO

Bearing Data

Ball Bearing Units

Bearing No. : B4

Dimensions

- d = 20
- D = 47
- B = 24.7
- C = 14
- r = 1.5
- S = 7
- S1 = 17.7
- S2 = 4.5
- G1 = M5*0.8
- d1 = 29
- Mass = 0.12 kg

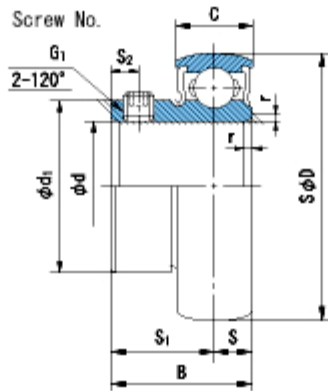

Basic Dynamic Load Rating Cr :	12800 N	INNER RING OUTER RING	
Basic Static Load Rating Cor :	6600 N	O.D.Surface Runout with Side :	-
Limiting Speed ;		Axial Runout with Bore :	-
		Axial Runout with Raceway :	-
		Width Variation :	-
		Radial Runout :	-
Grease Lubrication :	- rpm		
Oil Lubrication :	- rpm		