

ROECO

Bearing Data

Ball Bearing Units

Bearing No. : B2

Dimensions

- d = 15
- D = 40
- B = 22
- C = 12
- r = 1
- S = 6
- S1 = 16
- S2 = 4
- G1 = M5*0.8
- d1 = 24.7
- Mass = 0.09 kg

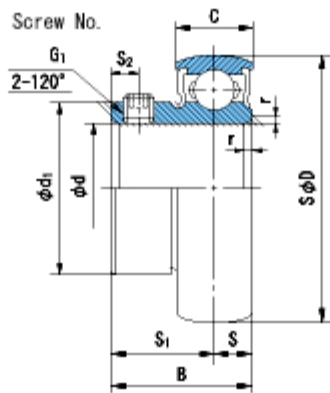

Basic Dynamic Load Rating Cr :	9550 N	INNER RING OUTER RING	
Basic Static Load Rating Cor :	4800 N	O.D.Surface Runout with Side :	-
Limiting Speed ;		Axial Runout with Bore :	-
		Axial Runout with Raceway :	-
		Width Variation :	-
Grease Lubrication :	- rpm	Radial Runout :	-
Oil Lubrication :	- rpm		